

## How to modify Android OS text correction

1. Access the control panel by pressing the home and power button simultaneously on your I-Series. These buttons are located on the back of your unit.

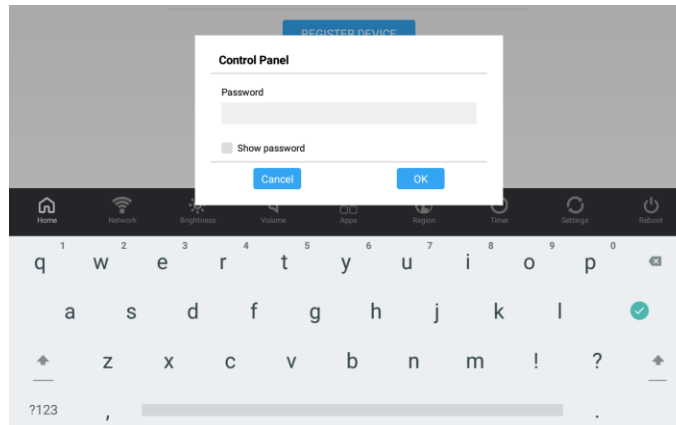

2. Enter in the password provided by The Perfect Plant Technical Support. Once you have entered the correct password you will see the Home Page populate with account information.

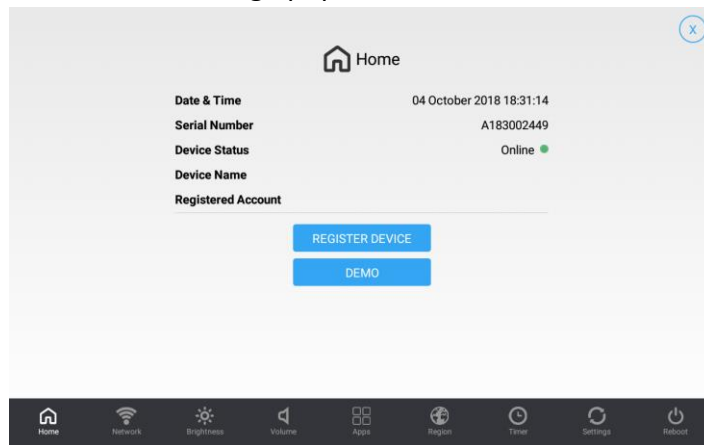

3. Select the Apps button on the bottom section.

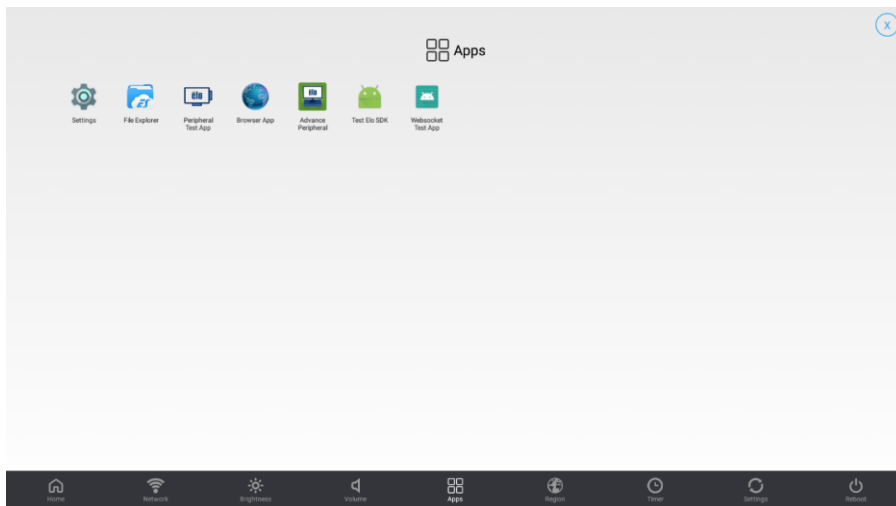

4. Next select “Setting” to access the Android OS settings page. Scrolling towards the bottom of the screen will reveal the “Language and input” option, select that option.

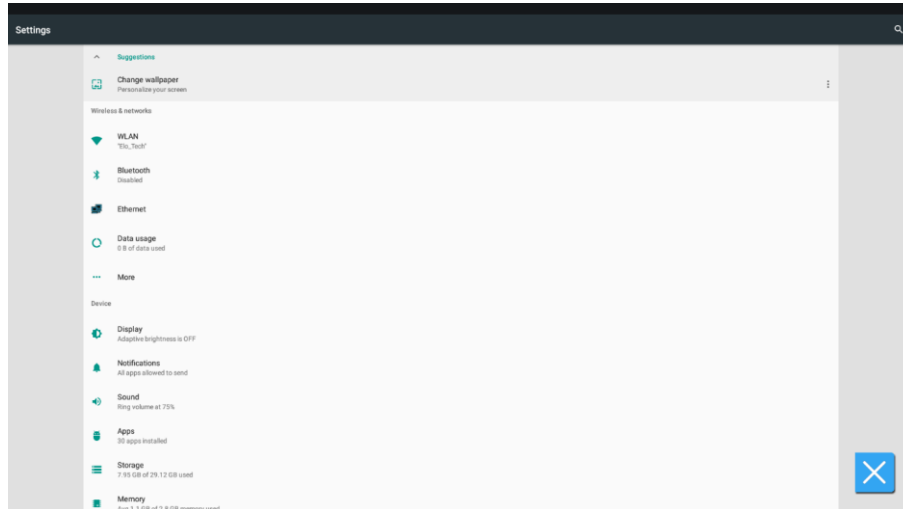

2<sup>nd</sup> half

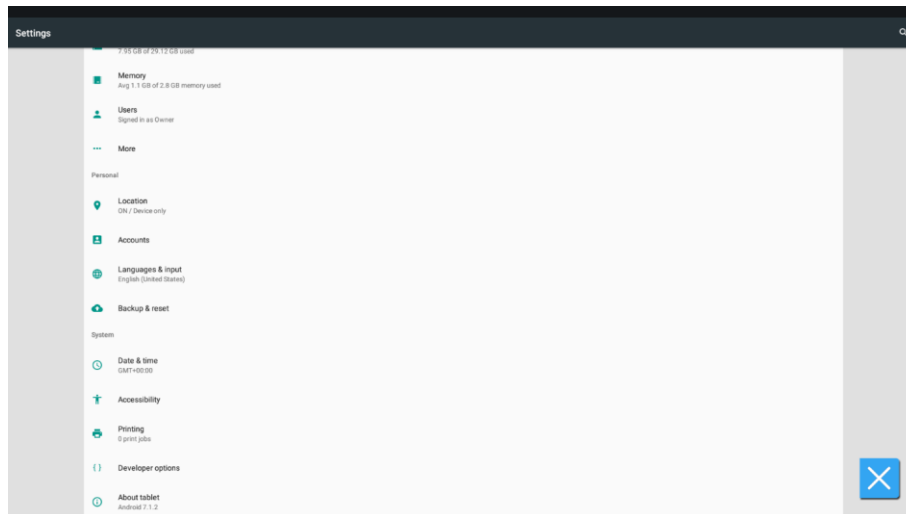

5. Under “Keyboard and input methods” select “Virtual Keyboard”

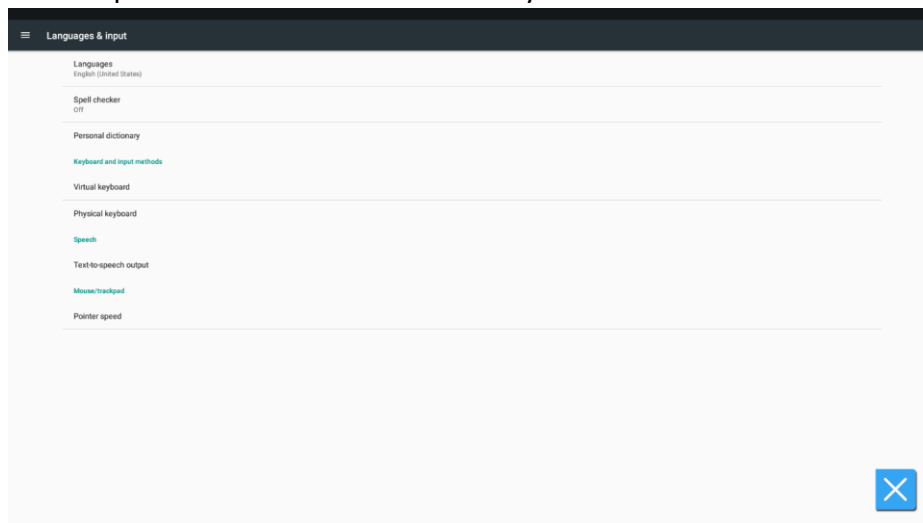

6. Next Select “Android Keyboard (AOSP)”

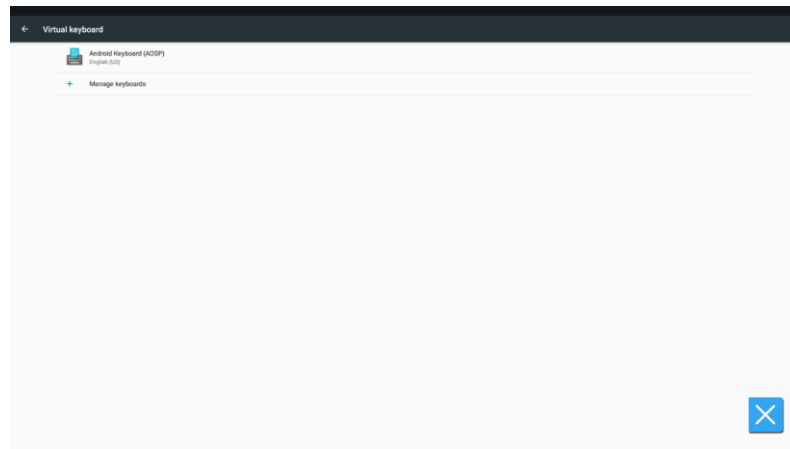

7. You should now see the option for “Text correction”

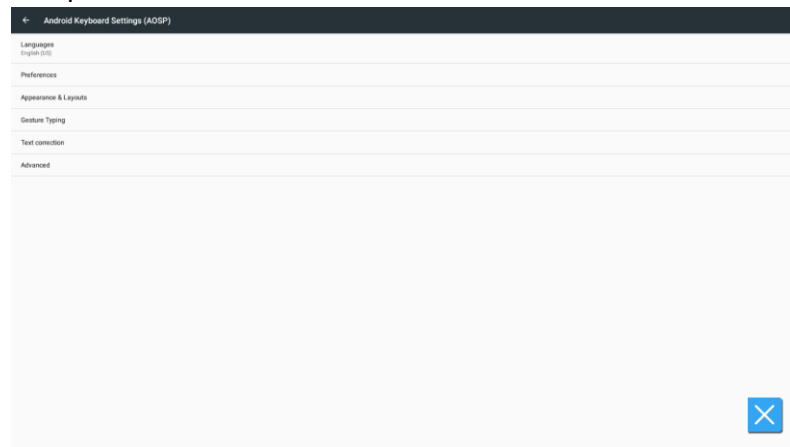

8. After selecting “Text correction” and entering that section, you will need to turn off the following options:
- a) Auto-Correction
  - b) Show correction suggestions
  - c) Personalized suggestions
  - d) Suggest Contact names
  - e) Next-word suggestions

Once you are done, press the blue X at the bottom right hand corner to return to your assigned content.

