



## Elo Touch Solutions

### X-Series RAM and HDD removal/replacement

TS06032016 Rev A

Solutions Architect of Technical Services

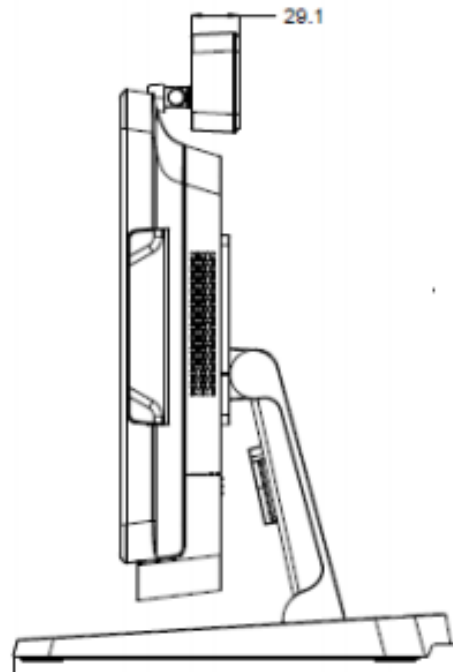
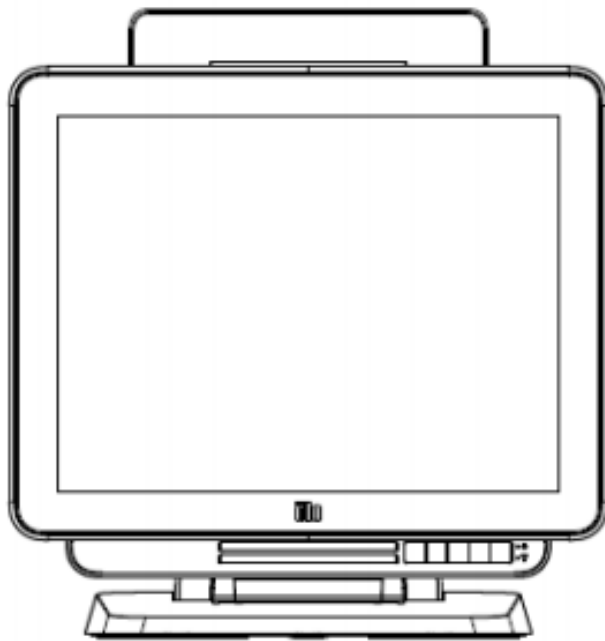

No part of this publication may be reproduced, transmitted, transcribed, stored in a retrieval system, or translated into any language or computer language, in any form or by any means, including, but not limited to, electronic, magnetic, optical, chemical, manual, or otherwise without prior written permission of Elo Touch Solutions, Inc.

## **Disclaimer**

The information in this document is subject to change without notice. Elo Touch Solutions, Inc. and its affiliates (collectively "Elo") makes no representations or warranties with respect to the contents herein, and specifically disclaims any implied warranties of merchantability or fitness for a particular purpose. Elo reserves the right to revise this publication and to make changes from time to time in the content hereof without obligation of Elo to notify any person of such revisions or changes.

## **Trademark Acknowledgments**

AccuTouch, CarrollTouch, Elo, Elo (logo), Elo Touch, Elo Touch Solutions, Elo TouchSystems, IntelliTouch, iTouch, SecureTouch, TouchTools and VuPoint are trademarks of Elo and its affiliates. Windows is a trademark of Microsoft Corporation.

# Table of Contents

**Introduction ..... 4**

**Tools Needed ..... 5**

**Procedure ..... 6**

# About This Manual

---

This document guides the user through removing/replacing the RAM and HDD on the Elo X-Series AIO touchcomputer.

The intended audience of this document includes: IT engineers, system engineers, electrical engineers, and end-users.

If after reading through this guide, you still have questions or need help getting your system up and running, please contact an Elo Touch Solutions Technical Representative. [www.elotouch.com](http://www.elotouch.com)

# Tools Needed

---

Hardware needed:

## Hardware:

- Flat protective surface
- Elo X-Series AIO Touchcomputer
- Small Philipps Screwdriver
- Replacement or Additional RAM and/or Hard Disk Drive (HDD)

**NOTE:** Below are the supported configurations:

## RAM

### **X2:**

- 2GB 1333MHz DDR3L SO-DIMM (Compatible with 4GB 1333MHz DDR3L SO-DIMM)
- 2 X DDR3L SO-DIMM slots with the dual-channel technology Support
- Supports up to 8GB of system memory (2 x 4GB)
- Supports DDR3L-1066/1333MHz memory modules

### **X3/X5/X7:**

- 4GB 1333/1600MHz DDR3L SO-DIMM (Compatible with 8GB 1333/1600MHz DDR3L SO-DIMM)
- 2 x DDR3 SO-DIMM slots with the dual-channel technology Support
- Supports up to 16GB of system memory (2 x 8GB)
- Supports DDR3-1333/1600; DDR3L-1333/1600MHz memory modules
- Supports Intel® Extreme Memory Profile (XMP)

## HDD (Hard Disk Drive)

### **X2:**

- 7mm 320GB 5400RPM 4K HDD
- 2 x SATA ports (SATA2/3.0Gb/s)

### **X3/X5/X7:**

- 7mm 320GB 5400RPM 4K HDD
- 2 x SATA ports (6.0Gb/s)
- Supports Raid 0, 1 feature (**X5/X7 Only**)
- Supports Intel Smart Response Technology (**X5/X7 Only**)
- Supports Intel Rapid Start Technology and Intel Smart Connect Technology (**X5/X7 Only**)

## SSD (Solid State Drive)

**X2/X3/X5/X7:** Support 7mm 64GB and 128GB SSDs

# Procedure

---

1. Place X-Series face down on a flat protective surface.



2. Using fingers pull up on the two tabs on the bottom of the back cover and push up and forward to remove the cover.



3. **To add or replace HDD:** Using the Removal Tool, unscrew the HDD retaining screw, remove retainer, slide HDD into available slot, replace retainer and tighten screw with removal tool.

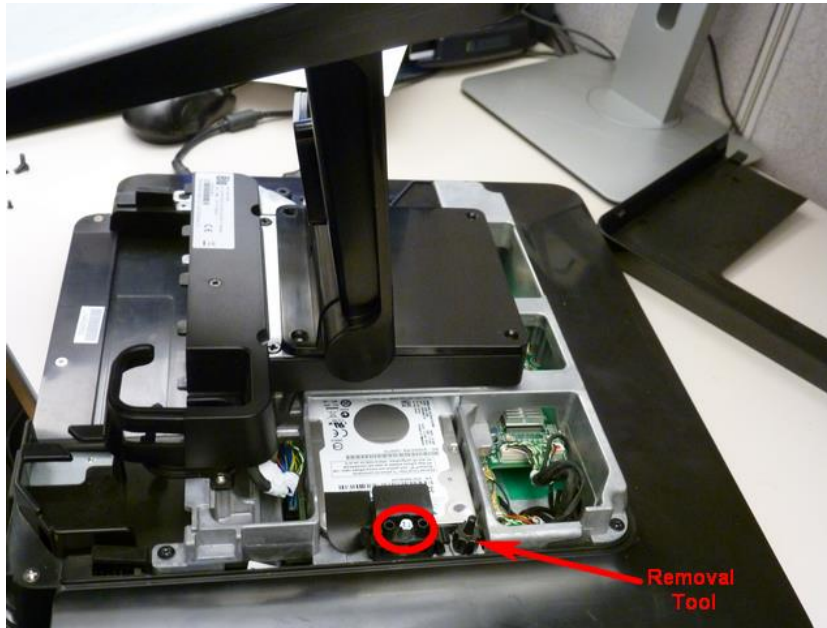

4. **To add or replace RAM:** Using fingers, or a small Philipp's screwdriver, remove thumb screw that holds the RAM cover in place and remove the RAM cover by pulling upwards.

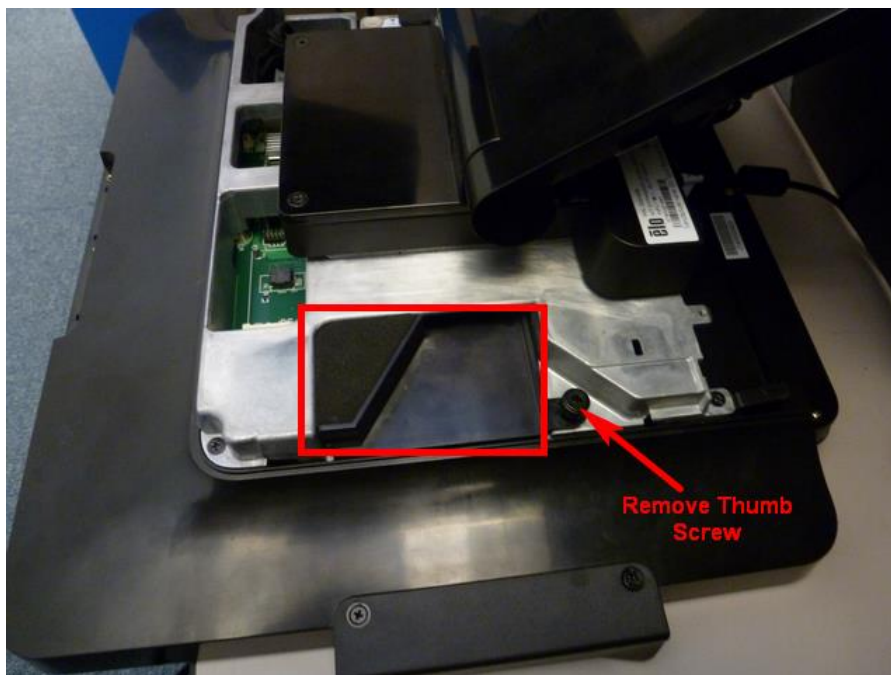

5. Once the RAM cover is removed, replace or add RAM to available RAM slots. Then place RAM cover back on and tighten with thumb screw.

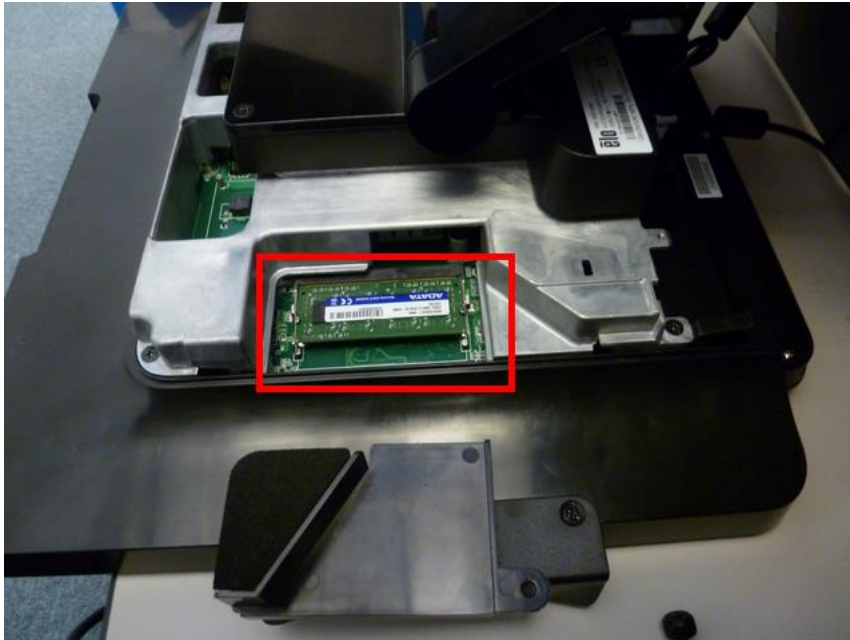

6. Replace back cover and you are finished.





Check out our website

**www.elotouch.com**

---

Get the latest...

- Product Information
- Specifications
- Upcoming events
- Press releases
- Software drivers

## Getting in Touch with Us

---

To find out more about the extensive range of Elo touch solutions, visit our website at [www.elotouch.com](http://www.elotouch.com), or simply call the office nearest you:

**North America**  
Elo Touch Solutions  
1033 McCarthy Blvd  
Milpitas, CA 95035

Tel 800-ELO-TOUCH  
Tel + 1 408 597 8000  
Fax +1 408 597 8050  
[customerservice@elotouch.com](mailto:customerservice@elotouch.com)

**Europe**  
Tel +32 (0) 16 70 45 00  
Fax +32 (0)16 70 45 49  
[elosales@elotouch.com](mailto:elosales@elotouch.com)

**Asia-Pacific**  
Tel +86 (21) 6106 7162  
Fax +86 (21) 6485 3981  
[www.elotouch.com.cn](http://www.elotouch.com.cn)

**Latin America**  
Tel 786-923-0251  
Fax 305-931-0124  
[www.elotouch.com](http://www.elotouch.com)